



TRANSPORTATION AND
ENVIRONMENTAL SERVICES
Design and Construction
150 Frederick Street
Kitchener Ontario N2G 4J3 Canada
Telephone: 519-575-4400
TTY: 519-575-4608
Fax: 519-575-4430
www.regionofwaterloo.ca

Refer To:
Andrew Doman, 519 575-4400 x3183

File No:
66114

Date:
September 16, 2022

To: Property Owners/Residents

Re: Contract 2022-158, Highway 7/8 Pedestrian and Cycling Bridge, City of Kitchener

Regional Council awarded Contract T2020-121 for the construction of a pedestrian and cycling bridge over Highway 7/8, to Eiffage GC Canada.

The contractor plans to commence this work around early October this year and complete the work by December 2023.

The work under this contract includes the following:

- A pedestrian and cycling bridge located at the end of Southmoor Drive with ramps extending west along Avalon Place and south along Chandler Drive and stairs at each end of the bridge;
- A steel truss bridge structure;
- A clear width of 4.0 metres on the bridge and connecting ramps;
- New sidewalk along the south side of Avalon Place connecting to the intersection of Avalon Place and Stirling Avenue;
- A new multi-use trail along Strasburg Road from the proposed bridge to the intersection of Strasburg Road and Ottawa Street;
- Lighting on the bridge and ramps; and,
- Enhanced landscaping in the vicinity of the bridge ramps as space permits.

Construction will mostly take place off roadway and the intersection works will be carried out with traffic being maintained.

The bridge is planned to be lifted into place over Highway 7/8 in 2023 and will require a short duration full closure of the Ministry of Transportation's Highway 7/8 between Fischer-Hallman Road and Homer Watson Boulevard.

General Information about this Project

We understand that some residents may have concerns with construction moving forward during the COVID-19 pandemic. Since March 23, 2020 the Province has included activities such as construction of roads, watermains, sewers and other municipal services as essential to ensure that these services continue to work properly and continue to meet our community's needs. In moving forward with construction projects, the Region of Waterloo is acting consistently with other local area municipalities and most other major municipalities in the Province. We will continue to evaluate and re-assess the situation as required.

Contractors working for the Region will employ policies and procedures to protect the health and wellness of workers and the community in general as part the contractor's Health and Safety Plan. Contractors will adjust these policies and procedures as required for each project and in accordance with relevant Federal, Provincial and Regional guidelines related to the COVID-19 pandemic issued at any given time. Region staff and consultants working for the Region will similarly be following all relevant COVID-19 guidelines during the course of construction.

Working Hours

Normal working hours are Monday to Friday from 7:00 a.m. to 7:00 pm. Occasional Saturday work and weekend work may occur from time to time.

Traffic Detours

Attached are maps which show the planned eastbound and westbound detour routes for when the bridge is to be lifted into place over Highway 7/8. Further communications regarding this will be provided in the weeks leading up to this closure in 2023.

Access to Businesses, Residences and Side Streets

Access to businesses, residences and intersecting local streets will be maintained to the greatest extent possible; however, disruptions will occur when construction activities are being completed directly adjacent to an entrance or local intersecting street. The Contractor will provide as much notice as possible to businesses and residences when construction activities are occurring adjacent to a property. If construction activities will make it such that you are

unable to park in your driveway for a short duration (including overnight), you will be directed to alternate parking locations, such as an adjacent street.

There may be periods of time when traffic will need to travel on a gravel surface, as well as times when traffic will need to be controlled with flag persons.

Please plan for some delays and travel carefully through the construction zone. We request that when driving or walking through and around the construction zone that you follow and obey the construction traffic signage for your safety and for the safety of the workers.

Grand River Transit (GRT) Service Changes

GRT buses may need to be rerouted. Please refer to the GRT website for the most current information on transit routes.

<https://www.grt.ca/en/schedules-maps/detours.aspx>

Garbage and Recycling (for properties within the active construction limits only)

During construction, access will be maintained for Waste Management for regular collection. Please refer to the Region of Waterloo's website regarding recent changes to collection of garbage and recycling at:

www.regionofwaterloo.ca/en/aboutTheEnvironment/waste-management.asp

Canada Post Mail Delivery (for properties within the active construction limits only)

Properties that receive door service mail delivery should not be affected while construction is taking place. If you do experience a disruption in your mail delivery please contact Canada Post at 1-866-607-6301 or go to their website www.canadapost.ca or contact the Region's on site representative.

Vibration, Dust, Mud

You may feel slight vibrations from the construction work. All efforts will be made to minimize adverse impacts from the construction including dust, mud and vibration.

Preconstruction Condition Survey

It is the Region of Waterloo's practice to offer preconstruction survey of buildings in the vicinity of imminent road construction activities. While we do not anticipate that buildings abutting or adjacent to the construction will be impacted by the road reconstruction, the preconstruction survey provides thorough documentation of the existing building condition, including any existing cracks or other visible structural or cosmetic defects of the exterior and interior of the property. If during or after the construction, residents/tenants experience any concerns with their property or suspect that damage has occurred as a result of the construction activities, the information from the preconstruction survey may prove helpful in resolving concerns.

Exterior and interior inspections will be carried out, including perimeter walkways and landscaping. There is no cost to the residents/owners for this service.

The Region has retained the firm Englobe to conduct the preconstruction survey of all buildings abutting or adjacent to the construction limits. You will be contacted by a staff member from Englobe to coordinate access to your property. Englobe will provide each property owner with a copy of their COVID-19 Preventative Measures for review prior to Englobe commencing any preconstruction survey. Please feel free to discuss directly with Englobe any concern you may have with their protocol. While the preconstruction inspection is voluntary, your permission and cooperation in helping us complete this survey is greatly appreciated.

Contact Information during Construction

Construction Questions/Concerns - During Normal Working Hours			
Name	Firm	Phone	Email
Clement Richet	Eiffage GC Canada	(905)-351-4655	Clement.RICHET@eiffage.com
Mike Ulozas	BT Engineering	(905)-709-4554	mike.ulozas@bteng.ca
Construction Concerns/Emergencies - After Hours and Weekends			
Clement Richet	Eiffage GC Canada	(905)-351-4655	Clement.RICHET@eiffage.com
Region of Waterloo Call Centre	Region of Waterloo	(519) 575-4400	
GENERAL PROJECT RELATED INQUIRIES			
Mike Ulozas	BT Engineering	(905)-709-4554	mike.ulozas@bteng.ca
Andrew Doman	Region of Waterloo	(519)-575-4400 x3183	adoman@regionofwaterloo.ca

Updates During Construction

Information about this project, including periodic updates will be available through the Region's website at:

https://www.regionofwaterloo.ca/en/living-here/resources/Documents/Current-Construction/DC_66114_InfoSheet.pdf

Every reasonable effort will be made during construction to minimize disruption and complete the work efficiently and cost effectively. We thank you in advance for your patience and cooperation.

Regards,



Andrew Doman, P.Eng.
Senior Engineer – Transportation Expansion
Design & Construction Division of Transportation & Environmental Services
Regional Municipality of Waterloo
150 Frederick Street
Kitchener ON N2G 4J3
519-575-4400 x3183
adoman@regionofwaterloo.ca

cc: Margaret Johnston, City of Kitchener Ward 8
Paul Singh, Councillor, City of Kitchener Ward 6
Berry Vrbanovic, Mayor, City of Kitchener
Tom Galloway, Regional Councillor
Michael Harris, Regional Councillor
Geoff Lorentz, Regional Councillor
Elizabeth Clarke, Regional Councillor
Marcos Kroker, Region of Waterloo
Mike Ulozas, BT Engineering.

Highway 7/8 Eastbound Detour during Bridge Lift

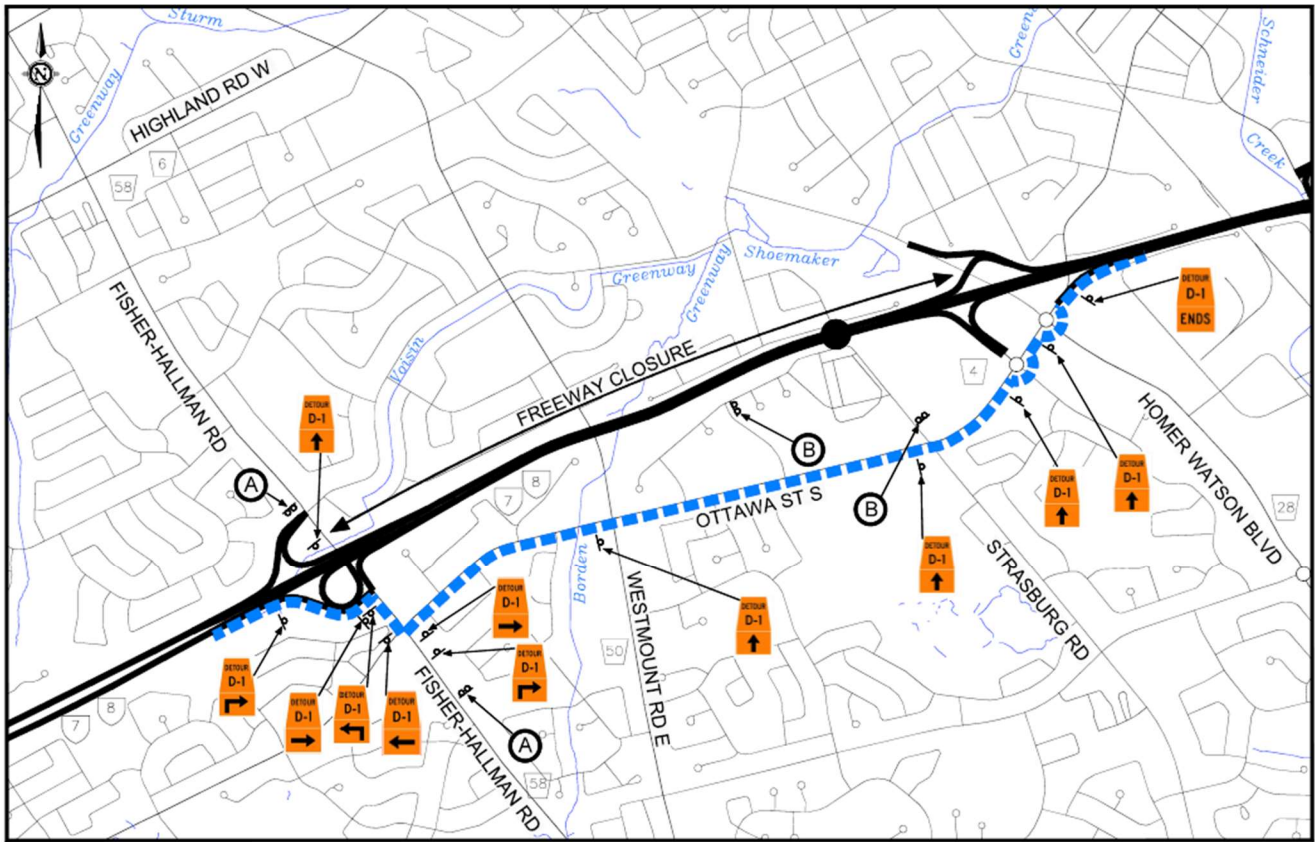

Highway 7/8 Westbound Detour during Bridge Lift

