



ENGINEERING AND
ENVIRONMENTAL SERVICES
Design and Construction
150 Frederick Street
Kitchener Ontario N2G 4J3 Canada
Telephone: 519-575-4400
TTY: 519-575-4608
Fax: 519-575-4430
regionofwaterloo.ca

Refer To:

Andrew Doman, 519-575-4757 x3183

File No:

66114

Date:

August 19, 2024

Dear Resident,

Re: Upcoming Highway 7/8 Full Closure between Fischer-Hallman Road and Homer Watson Boulevard Interchanges – Contract 2022-158, Highway 7/8 Pedestrian and Cycling Bridge, City of Kitchener

The Contractor is preparing to move the bridge in place over Highway 7/8 between the Fischer Hallman Rd and Homer Watson Blvd interchanges.

This operation will require rolling lane closures on Highway 7/8 starting at 8:00PM, moving into a full closure starting at midnight on Saturday August 24th. The Highway between these interchanges is expected to reopen to a single lane at midnight on Sunday August 25th with all lanes fully open by 5:00AM Monday August 26th.

Chandler Drive between Woodfern Court and Strasburg Road will also require a short duration closure of a few hours on August 25th to move the bridge to the crane position.

During the full closure, eastbound highway traffic will be diverted off at the Fisher Hallman Rd interchange and westbound highway traffic will be diverted off at the Homer Watson Blvd interchange. Ottawa Street will be used as the detour route and signage will be placed to direct motorists. Diagrams of these detours are attached.

It is strongly encouraged to plan ahead as significant delays are expected in these affected areas during the highway closure.

Should these operations need to be rescheduled, notifications will be provided with details.

We thank you in advance for your patience and cooperation.

If you have any questions regarding this project, please contact the undersigned or visit:

https://www.regionofwaterloo.ca/en/living-here/resources/Documents/Current-Construction/DC_66114_InfoSheet.pdf

Yours truly,

A handwritten signature in blue ink, appearing to read 'Andrew Doman', with a long horizontal stroke extending to the right.

Andrew Doman, P.Eng.

Senior Engineer, Transportation Expansion
Design and Construction Division
Engineering and Environmental Services

cc: Stephanie Brasseur, City of Kitchener
Satinderjit Bahia, Region of Waterloo
Marcos Kroker, Region of Waterloo
Mayor Berry Vrbanovic, City of Kitchener

AD/to

Highway 7/8 – Eastbound Detour

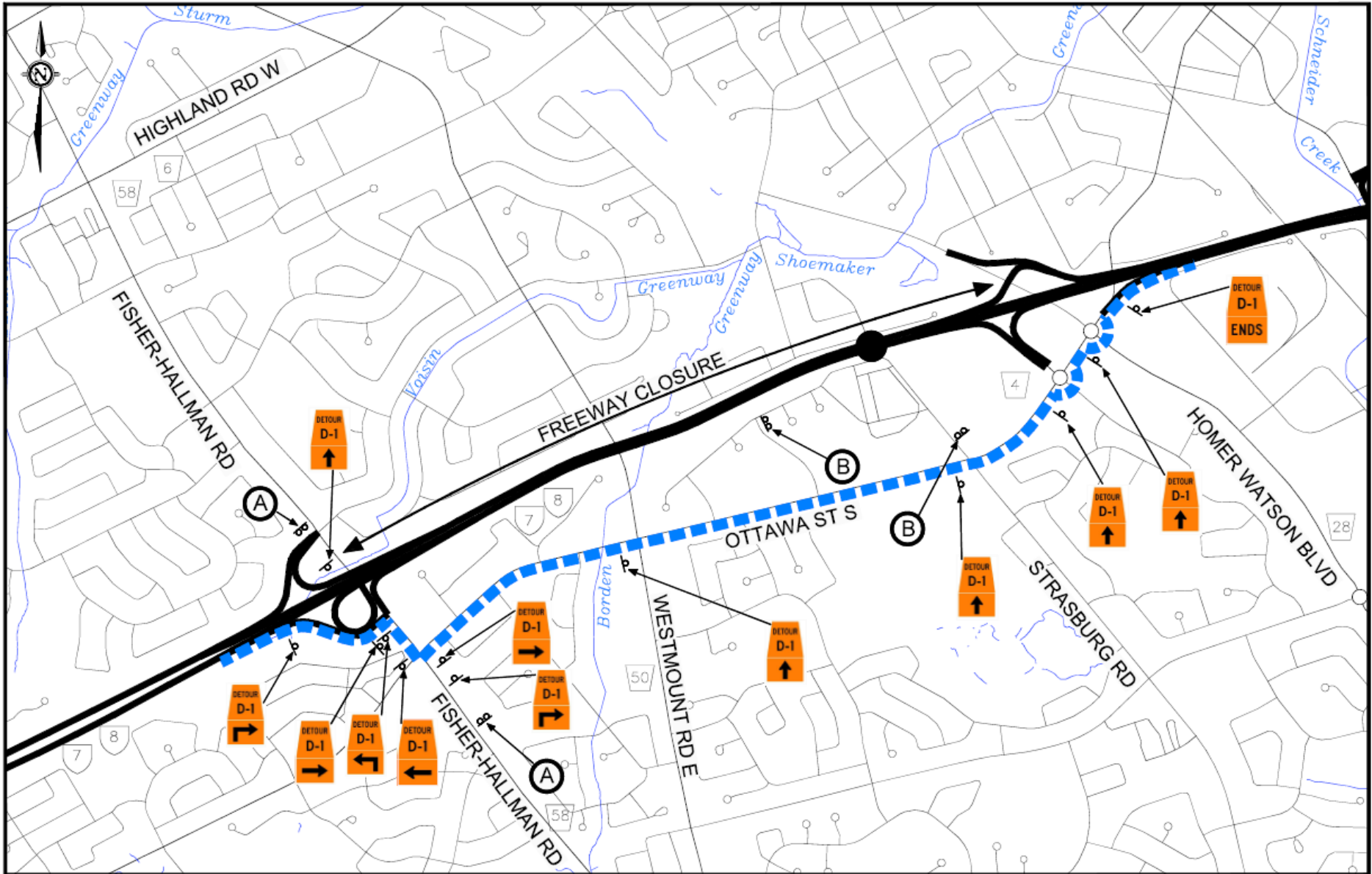

Highway 7/8 – Westbound Detour

