

# Construction notice:

## Fountain Street North, Woolwich

### September – November 2025

---

#### Flanders Road to 270m south of railroad bridge

Notice date: August 27, 2025

#### About the project

The Region of Waterloo is installing a new watermain along Fountain Street North from Flanders Road/Horseshoe Crescent to approximately 270m south of the railroad bridge. During this work the asphalt, shoulders and boulevards on the road will also be replaced.

This project aims to improve the water supply system in the Township of Woolwich and support the growing community.

#### Timing — starts September 15, 2025

Construction will start on or around September 15 and go until November 2025.

The next phase of construction will start up again in the spring and go until fall 2026.

#### Closures and lane reductions

Two-way traffic will be maintained at all times on Fountain Street North. Sections of the southbound lane will be closed and temporary automated signals will be in place.

Flanders Road and Horseshoe Crescent South will be closed at Fountain Street North.

#### Detour

Local traffic from Flanders Road will be detoured via Townsend Drive to Fountain Street North and Horseshoe Crescent North.

Traffic from Horseshoe Crescent South will be redirected to Horseshoe Crescent North at Fountain Street North. Please refer to the attached map for detour routes.

Police, Fire, and Paramedic Services have been notified to ensure emergency response is not affected.

#### Pedestrian access

The pedestrian and cycling in this area will remain accessible during the project. Pedestrians and cyclists should follow the signs as they move through the site.

## **Pre-construction property assessment**

Englobe Corp will offer nearby properties a free, optional pre-construction condition assessment. This records the building's current condition and can be used to help resolve any concerns if damage is suspected during construction.

## **Dust, mud and vibration**

You may notice slight vibrations from the contractor's equipment during construction. All efforts will be made to minimize adverse impacts from construction including dust, mud and vibration.

## **Nearby construction projects**

The Township of Woolwich will also be undertaking the Randall Drain Culvert Replacement Project near the intersection of Fairway Road and Fountain Street during fall and winter 2025/2026. For more information, please visit the project website at [www.engagewr.ca/randall-drain-culvert-replacement](http://www.engagewr.ca/randall-drain-culvert-replacement)

## **More information**

To learn more about this project visit [www.regionofwaterloo.ca/fountain-street-north](http://www.regionofwaterloo.ca/fountain-street-north)

## **Contact information**

Padraig Keating, Senior Engineer  
Design and Construction, Region of Waterloo  
[Pakeating@regionofwaterloo.ca](mailto:Pakeating@regionofwaterloo.ca)

Service First Contact Centre: 519-575-4400

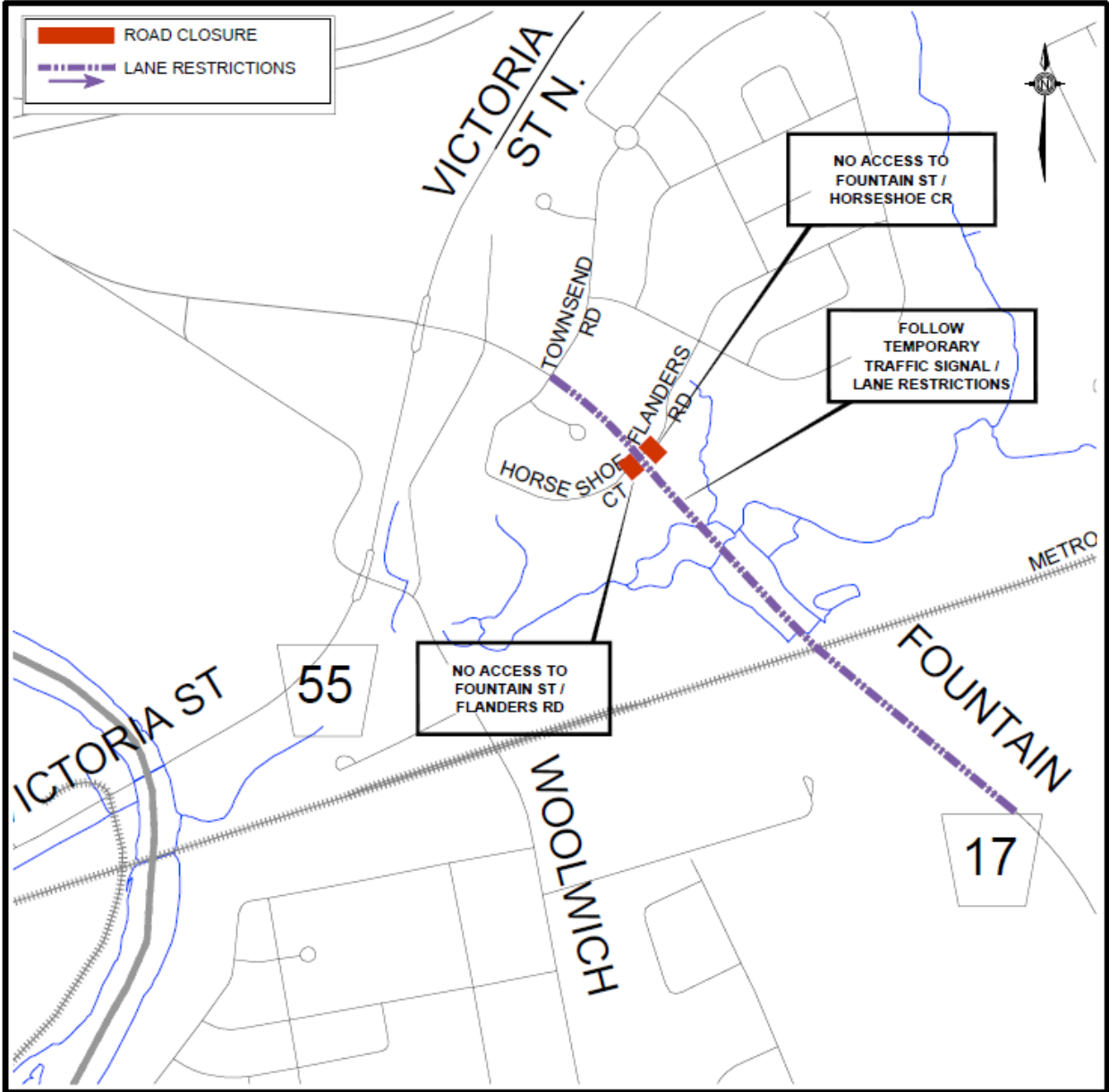

 <p>Region of Waterloo</p>	<p><b>Fountain Street North Detour Watermain Installation Woolwich</b></p>
---	--