



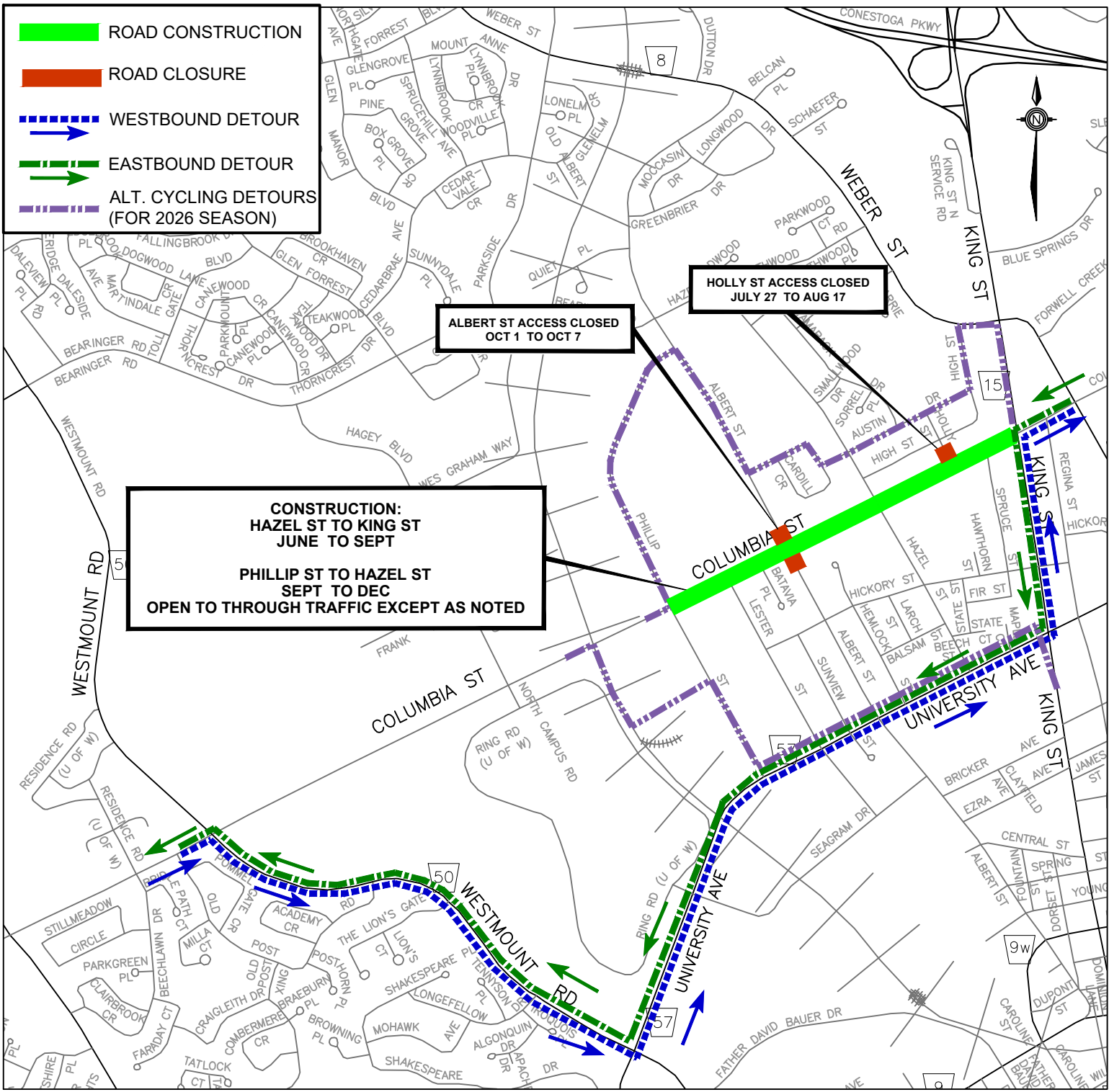

-  ROAD CONSTRUCTION
-  ROAD CLOSURE
-  WESTBOUND DETOUR
-  EASTBOUND DETOUR
-  ALT. CYCLING DETOURS (FOR 2026 SEASON)



Columbia Street Detour Route Westmount Road to King Street Phase 1 Construction - Phillip St to King St